

Blaty CSS-BL.1 i CSS-BL.2 - po 1 szt.
 Blaty pod oknami a'la parapety - wymiary orientacyjne - należy dokonać dokładnych pomiarów przed przystąpieniem do realizacji

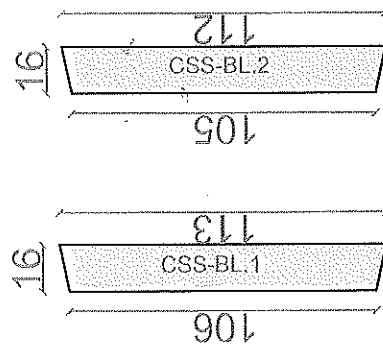

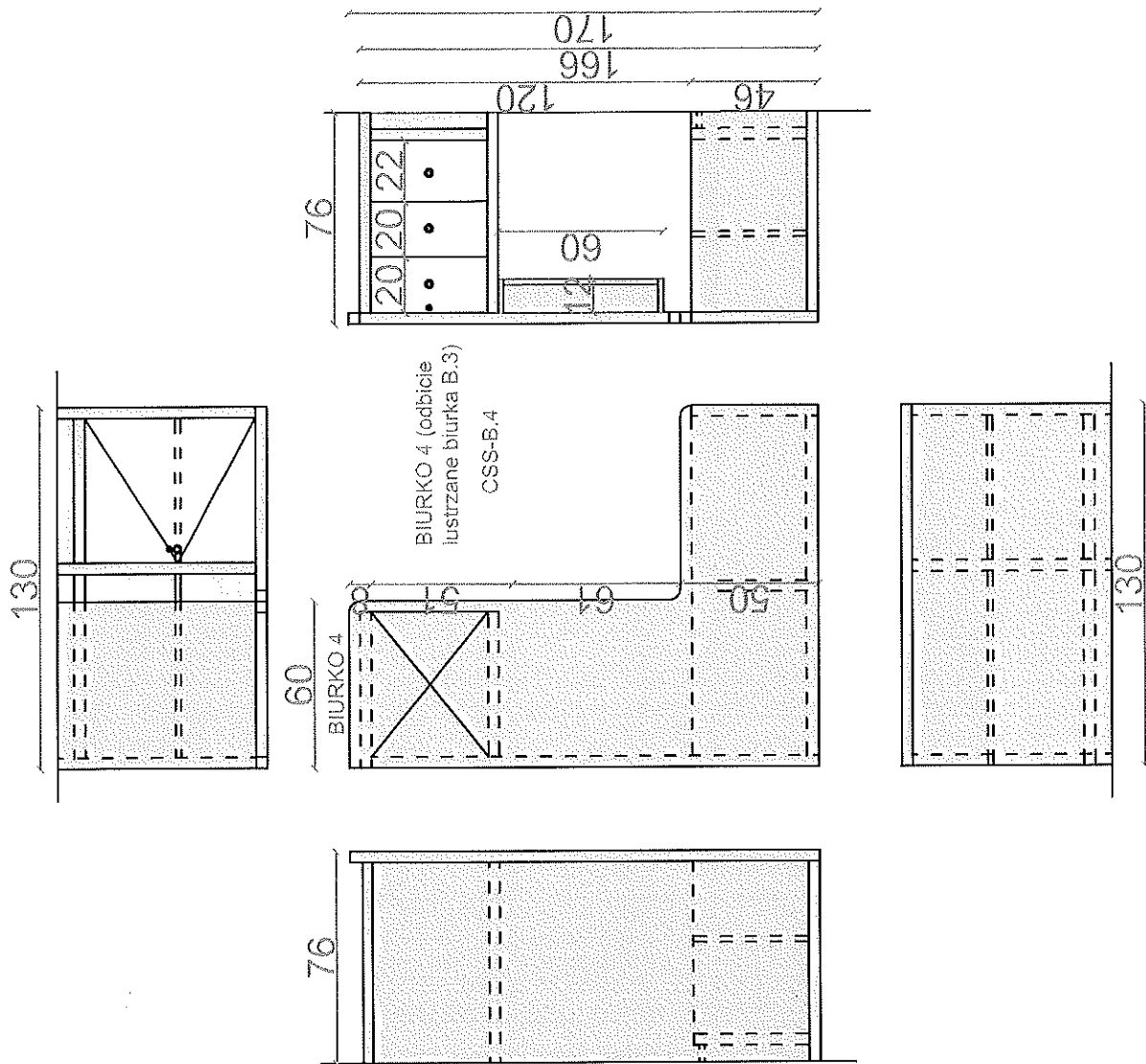

ZAL. 9

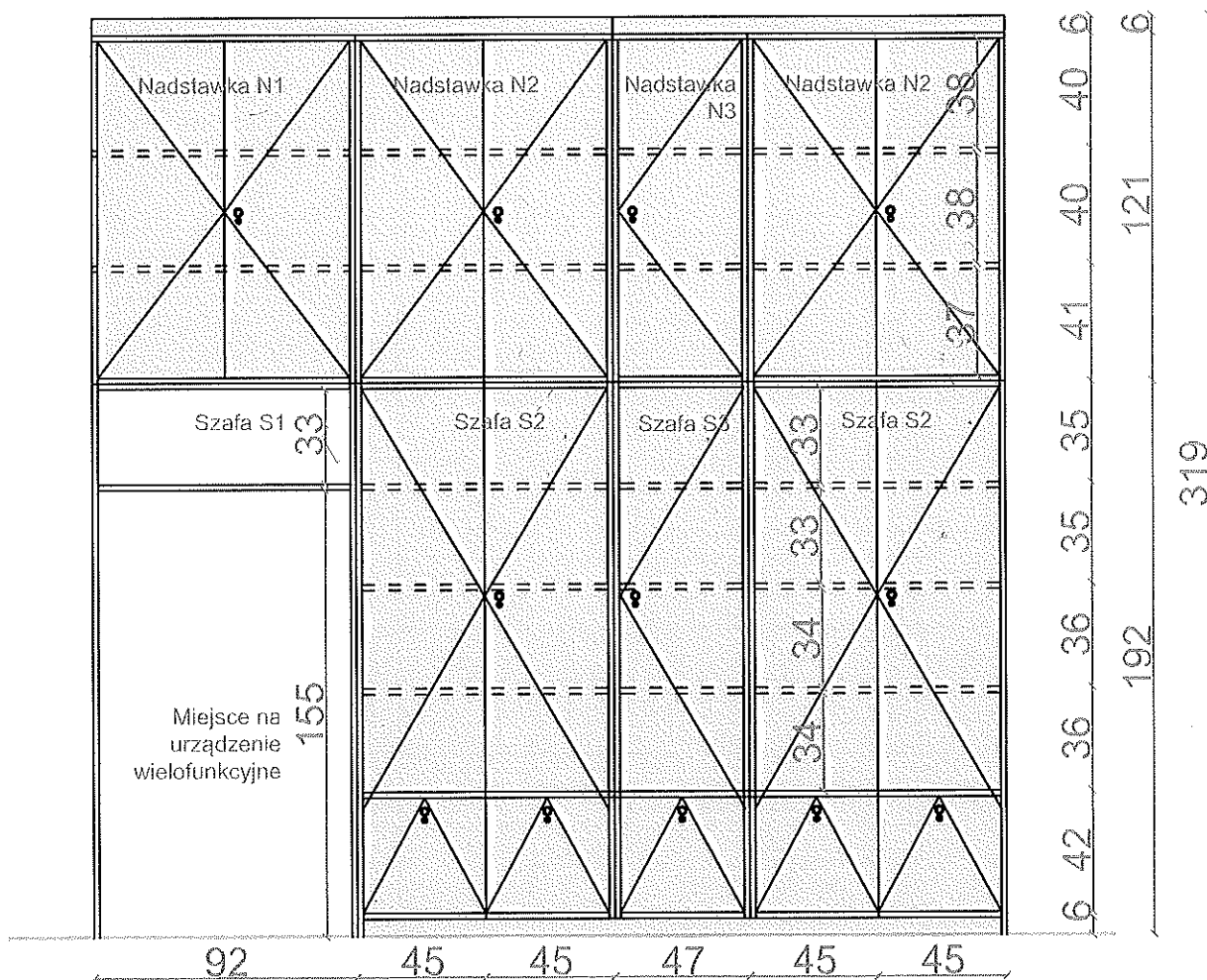
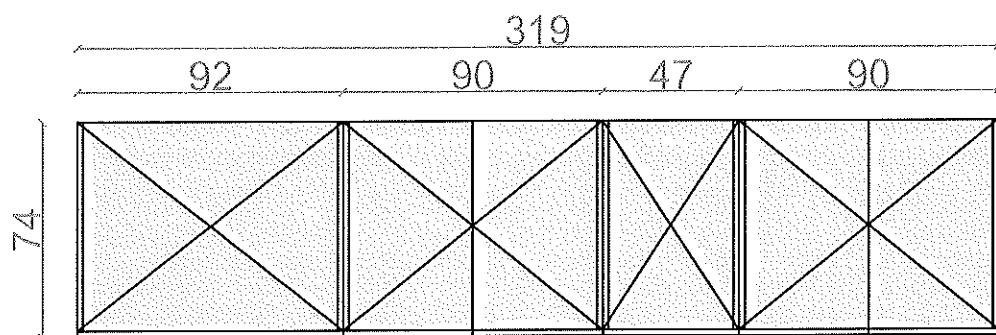

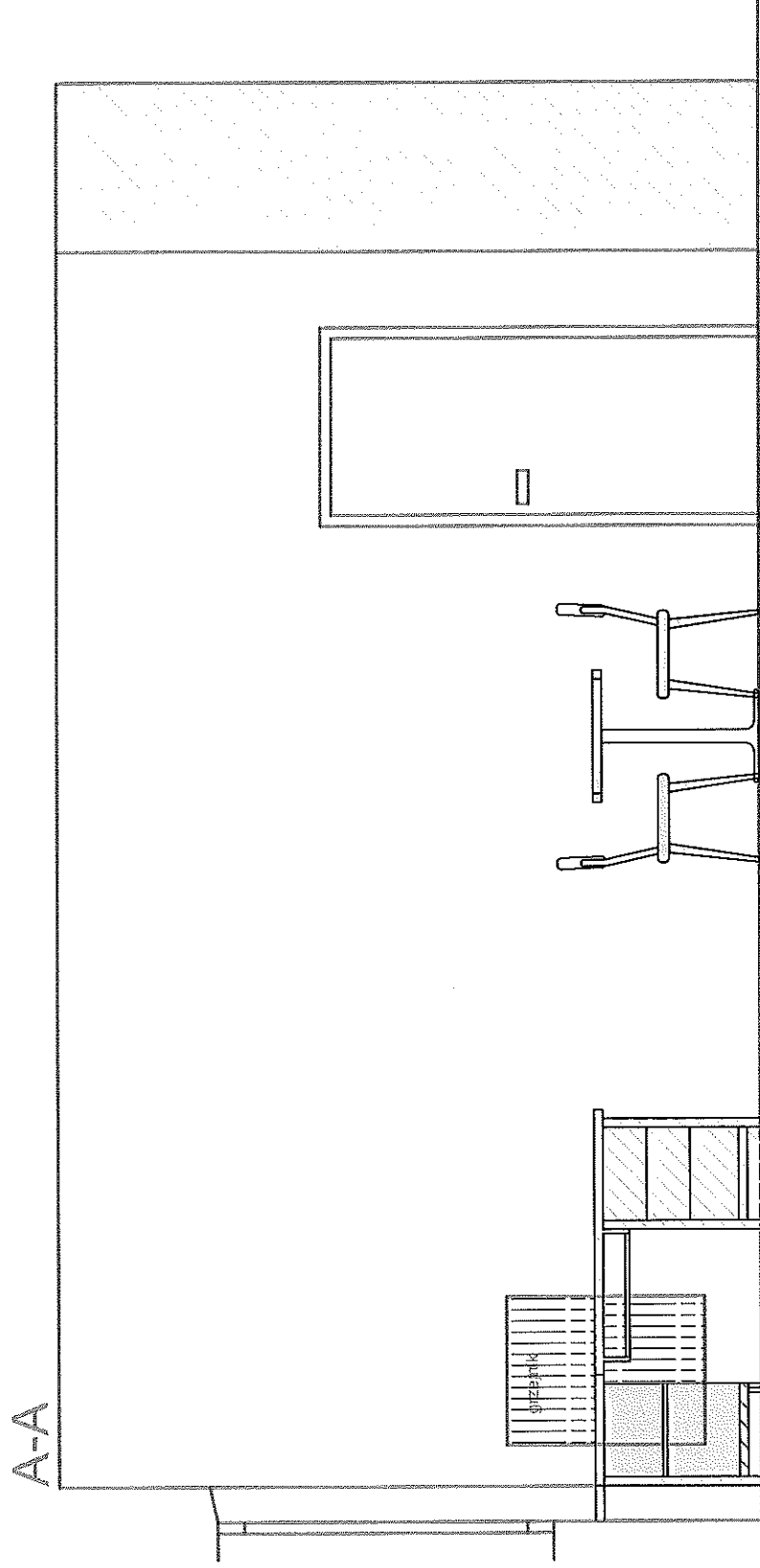

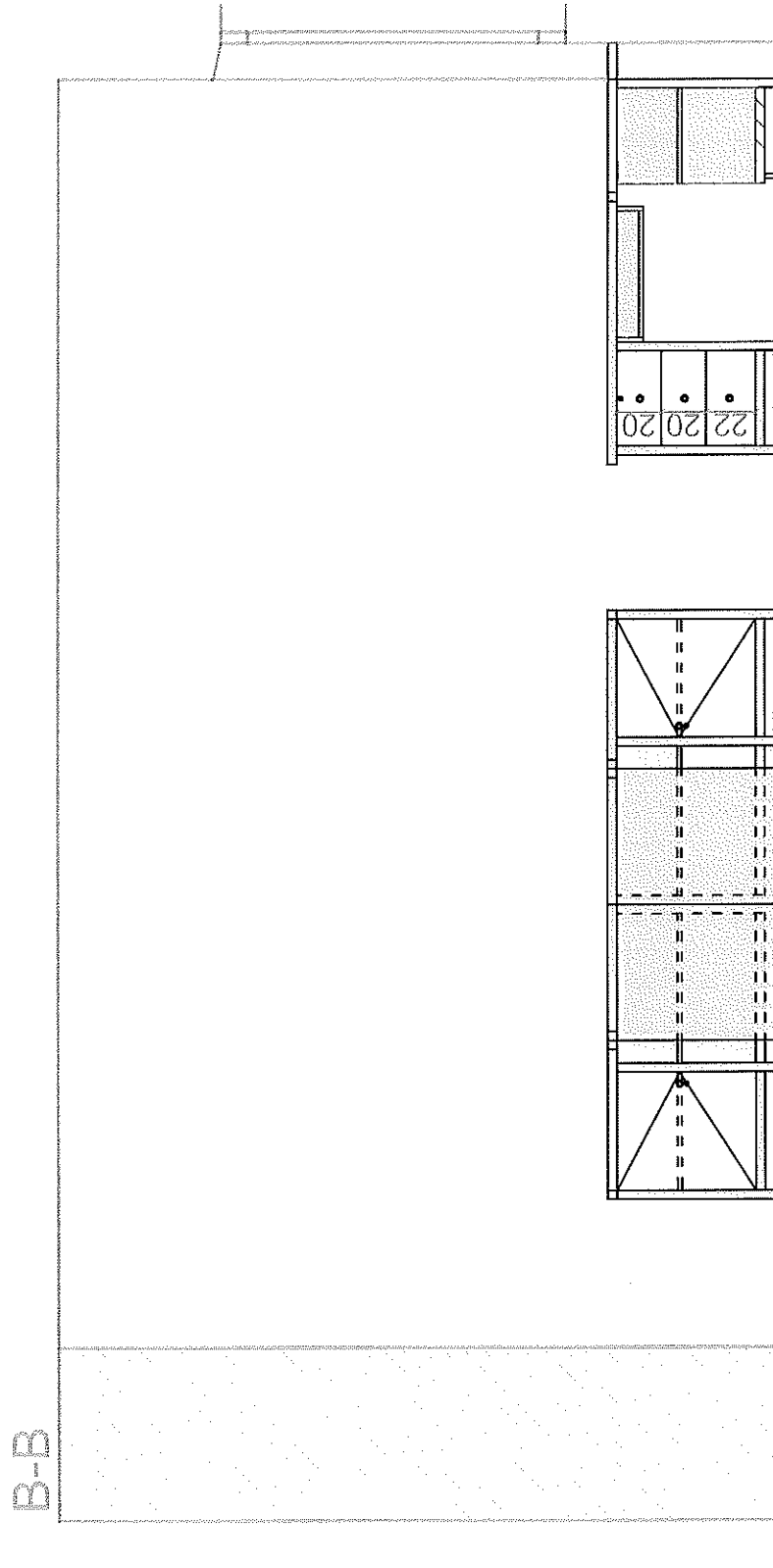

C-C

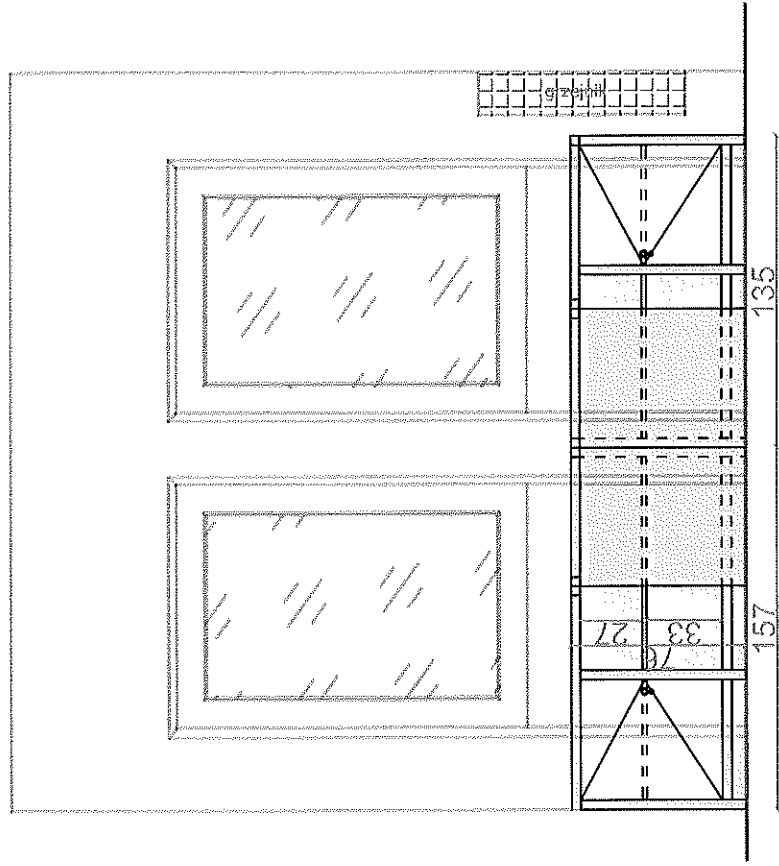

This architectural floor plan shows a laboratory room with the following features and dimensions:

- Overall Dimensions:** The room is 141.5 units wide and 319 units deep.
- Entrance:** Located on the left wall, with a width of 60 units.
- Seating Area:** Two chairs are positioned near the entrance, each with a width of 60 units.
- Workstations:** Four workstations are arranged in a row, labeled BIURKO 1, BIURKO 2, BIURKO 3, and BIURKO 4. Each workstation is 60 units wide.
- Storage/Equipment:** Two units labeled CSS-B.1 and CSS-B.2 are located near the workstations, each with a width of 60 units.
- Dimensions and Spacing:**
 - Distance from entrance to first workstation: 89 units.
 - Distance between workstations: 51 units.
 - Distance from last workstation to right wall: 61 units.
 - Distance from entrance to first workstation: 72 units.
 - Distance between workstations: 170 units.
 - Distance from last workstation to right wall: 83.67 units.
 - Distance from entrance to first workstation: 106 units.
 - Distance between workstations: 135 units.
 - Distance from last workstation to right wall: 105 units.
 - Distance from entrance to first workstation: 18.5 units.
 - Distance between workstations: 84 units.
 - Distance from last workstation to right wall: 56 units.
- Section Lines:** A-A and B-B are marked across the plan.